

PI 05/2022

Fully insulated signal tap

application area: for protruding contacts with signal cable connection

specifications:

connection type:	connection of a signal cable
cable cross section:	from 1,5 up to 2,5 mm ²
protection class:	up to IP64 possible
material:	TPE UL 94 V0



signal cable protection in the half section:

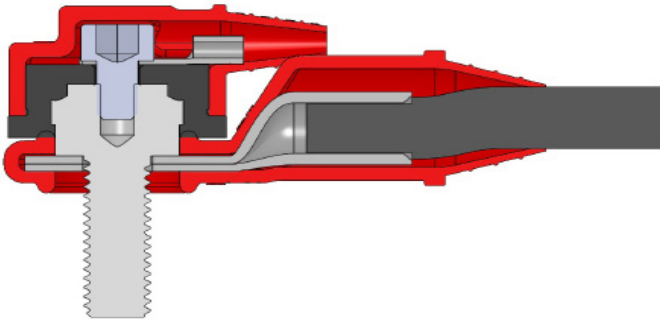

- the signal cable is connected to the insulating screw with the use of a forked cable lug and is comprehensively insulated with another cover cap

the advantages of fully insulated signal tap

→ Fully insulated signal tap

- fully insulated signal tap with every insulation screw possible
- can also be retrofitted for all Lugsulation©-sets
- clean signal tap insensitive to dirt
- signal tap is rotatable 360°

→ Contact- & corrosion protection

- protection against contact, aggressive media, corrosion and fault currents
- protection class IP64
- increased safety and preservation of conductivity

→ Individual signal cable connections 1,5 mm² bis 2,5 mm²

- no additional surface treatment necessary
- variable design

→ Your advantages

- safe and easy self-assembly on site
- reduction of maintenance and follow-up costs due to longer-lasting system and fail-safe operation
- increased occupational safety due to contact protection

Our company is certified according to DIN EN ISO 9001.

For more information please visit our homepage or contact us directly:

